



Designers' Choice

# PC QUICK-FIT TERMINALS



Underwriters Laboratories, Inc.  
Recognized Component Program — UL File Number E201546

UL file number E201546 has been assigned to Keystone Electronics' "Quick-Fit" terminals (see pages 29-31) indicating recognition by Underwriters Laboratories Inc. that they are in compliance with their component program.

Underwriters Laboratories Inc. component program assures that "Quick-Fit" terminals meet the dimensional and performance requirements of the National Electrical Manufacturers Association specification number NEMA2-1982-(1988) and UL310.

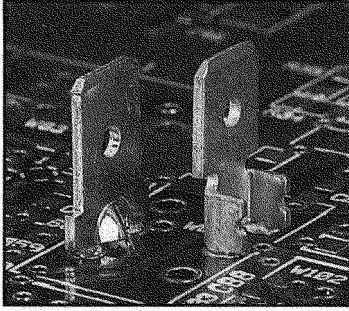

.250 TAB			.250 TAB			DUAL .110/.250 TAB		
CAT. NO. 1287	MATERIAL .032 Brass, Tin Plate	MTG. HOLES .052 Dia.	CAT. NO. 1287-ST	MATERIAL .032 Brass, Tin Plate	MTG. HOLES .052 Dia.	CAT. NO. 1282	MATERIAL .032 Brass, Tin Plate	MTG. HOLES .052 Dia.
CAT. NO. 4901	MATERIAL .032 Brass, Tin Plate	MTG. HOLES .067 Dia.	CAT. NO. 4902	MATERIAL .032 Brass, Tin Plate	MTG. HOLES .067 Dia.	CAT. NO. 4908	MATERIAL .032 Brass, Tin Plate	MTG. HOLES .052 Dia.
CAT. NO. 1289	MATERIAL .032 Brass, Tin Plate	MTG. HOLES .052 Dia.	CAT. NO. 1289-ST	MATERIAL .032 Brass, Tin Plate	MTG. HOLES .052 Dia.	CAT. NO. 1281	MATERIAL .032 Brass, Tin Plate	MTG. HOLES .052 Dia.

NOTE: .250" TAB HAND INSERTION TOOL; CAT. NO. 1288, SEE PAGE 32

# PC QUICK-FIT TERMINALS

Designers' Choice



.110/ .187/ .205/ .250 PC QUICK-FIT MALE TYPES



**.205 TAB**

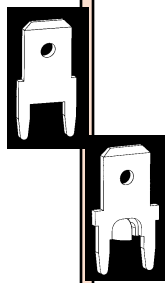
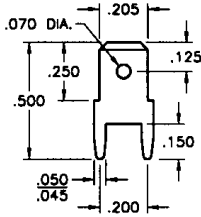

CAT. NO.	MATERIAL	MTG. HOLES
1286	.020 Brass, Tin Plate	.046 Dia.
1213	.032 Brass, Tin Plate	.052 Dia.

**.205 TAB**

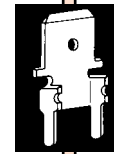
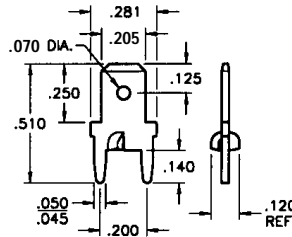

Sturdi-Mount

CAT. NO.	MATERIAL	MTG. HOLES
1286-ST	.020 Brass, Tin Plate	.046 Dia.
1213-ST	.032 Brass, Tin Plate	.052 Dia.

**.187 TAB**

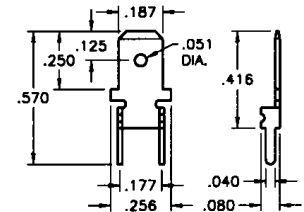

Sturdi-Mount

CAT. NO.	MATERIAL	MTG. HOLES
4900	.020 Brass, Tin Plate	.043 Dia.

**.187 TAB**

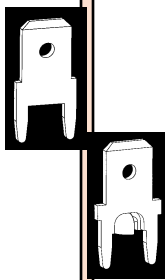
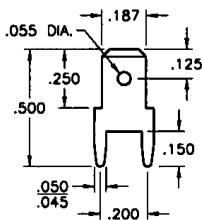

CAT. NO.	MATERIAL	MTG. HOLES
1285	.020 Brass, Tin Plate	.046 Dia.
1212	.032 Brass, Tin Plate	.052 Dia.

**.187 TAB**

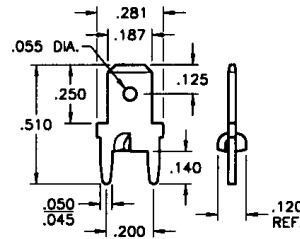

Sturdi-Mount

CAT. NO.	MATERIAL	MTG. HOLES
1285-ST	.020 Brass, Tin Plate	.046 Dia.
1212-ST	.032 Brass, Tin Plate	.052 Dia.

**.110 TAB**

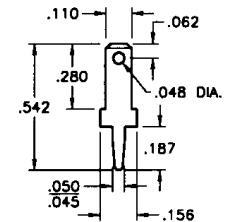

CAT. NO.	MATERIAL	MTG. HOLE
1267	.020 Brass, Tin Plate	.046 Dia.
1211	.032 Brass, Tin Plate	.052 Dia.

**.110 TAB**

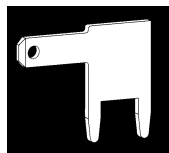
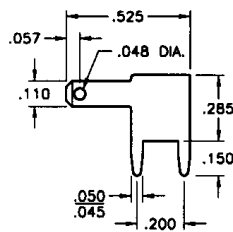

CAT. NO.	MATERIAL	MTG. HOLES
4903	.020 Brass, Tin Plate	.046 Dia.
4906	.032 Brass, Tin Plate	.052 Dia.

**.187 TAB**

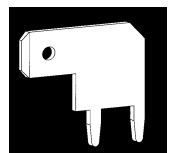
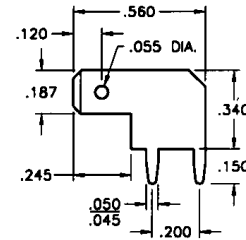

CAT. NO.	MATERIAL	MTG. HOLES
4904	.020 Brass, Tin Plate	.046 Dia.
4907	.032 Brass, Tin Plate	.052 Dia.

**.250 TAB**

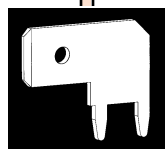
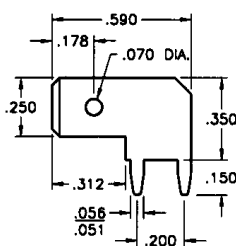

CAT. NO.	MATERIAL	MTG. HOLES
4966	.032 Brass, Tin Plate	.056 Dia.

**.250 TAB**

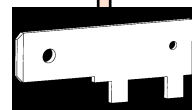
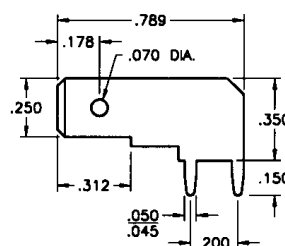

CAT. NO.	MATERIAL	MTG. HOLES
1266	.032 Brass, Tin Plate	.052 Dia.

**.250 TAB**

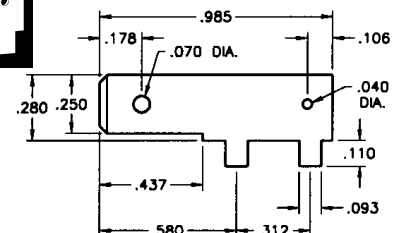

CAT. NO.	MATERIAL	MTG. HOLES
1265	.032 Brass, Tin Plate	.106 Dia.